

FEEDALL Model 2500-C Elevating Hopper Feeder

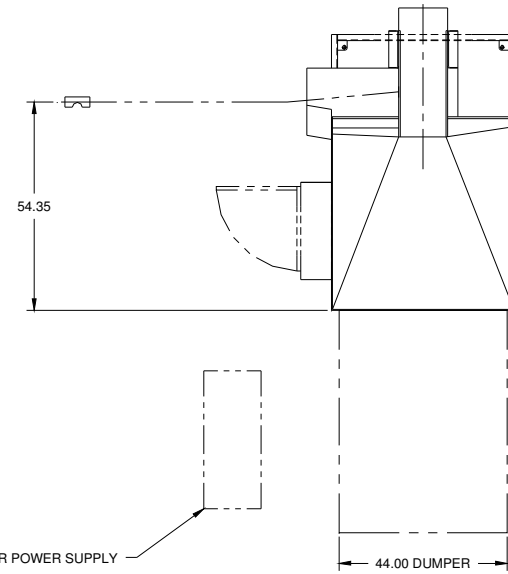

- APPLICATION:** Feed from a random loaded, floor mounted hopper, Engine Bulkhead Insert Forgings. Forgings are elevated out of the hopper via a cleated belt and fed in a continuous, end-to-end stream into an air-operated rotary orienting device. The orienting device will release one forging at a time laying flat with the semi-circle side oriented all the same way in a continuous end-to-end stream to a Rotary Transfer Machine.
- BELT WIDTH:** 12" Wide Elevating Belt
- DRIVE:** 3/4 HP/AC Motor w/Variable Speed Drive and Overload Relief Clutch
- HOPPER CAPACITY:** 14 cu.ft. - 1/4" HRS (minimum) w/Air-Operated Oscillating Hopper Bottom
- PARTS FED (SIZE):** Engine Bulkhead Insert Forgings
- FEED RATE:** 720 Parts/Hour (12 Parts/Minute)
- MACHINE FED:** ENTRUST Rotary Transfer Machine

FEEDALL Model 2500-C Elevating Hopper Feeder



3,000# HYDRAULIC TUB DUMPER TO HANDLE CONTAINER
40-1/2" (DUMP SIDE) x 33-1/2" LG. x 25-1/4" HIGH

